

# How to Find Cardiac Procedures

*Starting from Admitting on the 3rd floor*

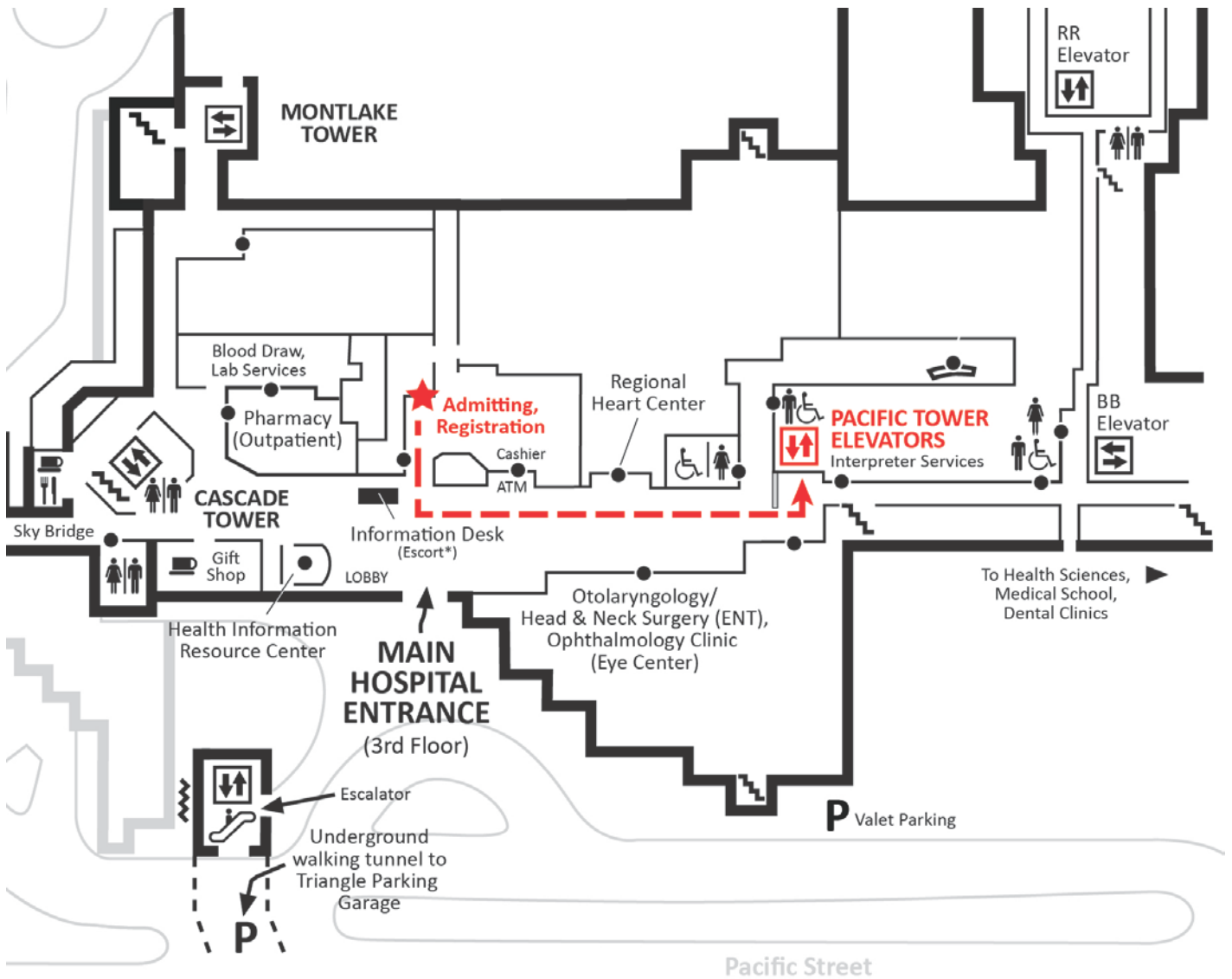

<b>FLOOR</b> <b>3</b>	<b>KEY</b>	Elevator	Food	Phone
		Escalator	Restrooms	Coffee (1st & 3rd Floors)
		Parking	Stairs	Wheelchair access

Rev. 09/2016

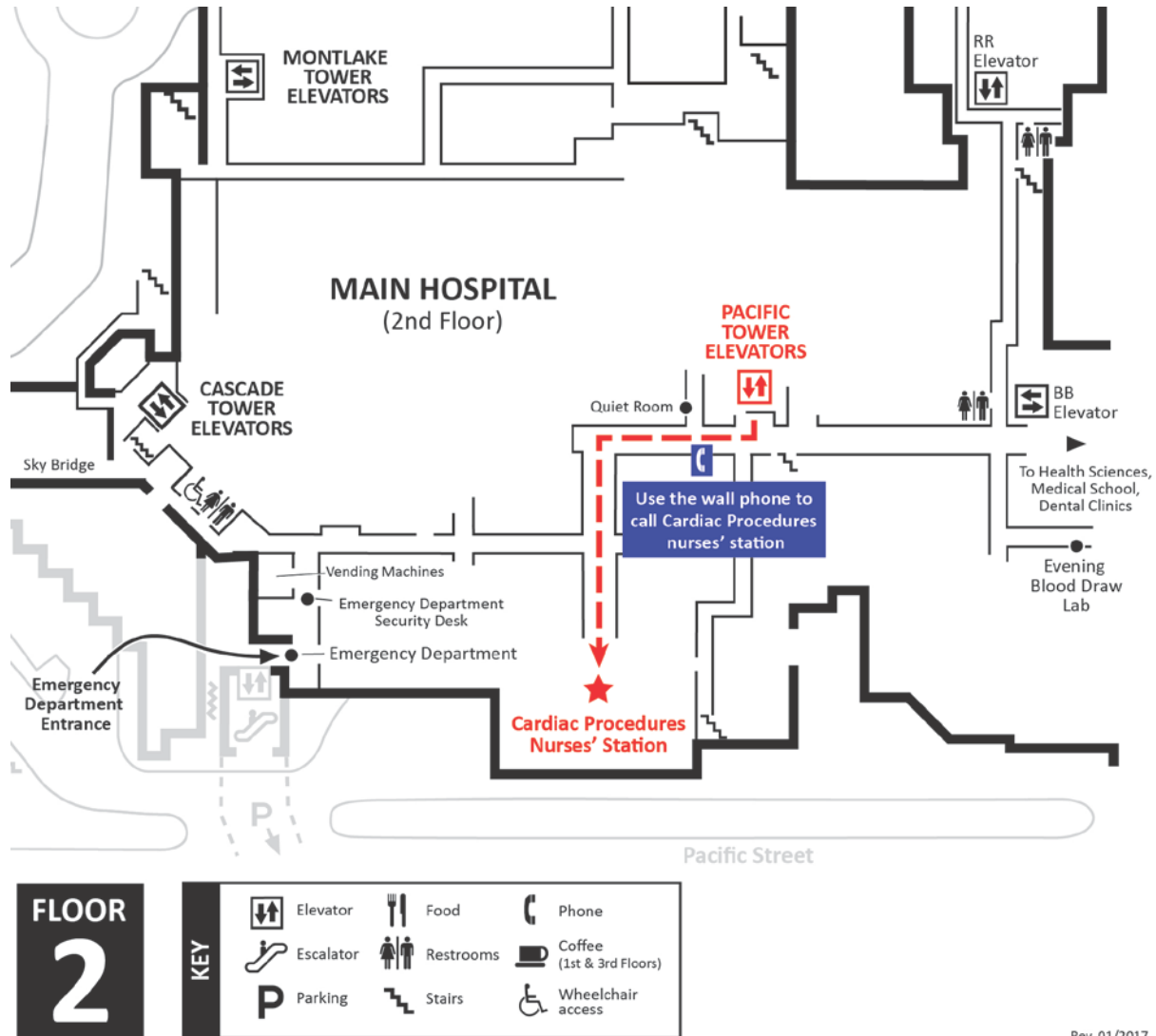

## For Family and Friends

During the procedure:

- We suggest you wait in the Plaza Café on the 1st floor, or in one of the public waiting areas on the 3rd floor. Ask at 3rd floor Information Desk for a map or directions.
- Keep your pager on you.
- **When the pager vibrates:**
  - **Return to the wall phone by the Pacific elevators on the 2nd floor right away.**
  - **Pick up the phone. It will auto-dial the Cardiac Procedures nurses' station.**
- Return the pager to the Cardiac Procedures nurses' station before you leave.
- If you have questions or concerns, use a hospital phone to call the Cardiac Procedures nurses' station: 87146.